

**GANGAJALGHATI INDUSTRIAL PARK
DIST. BANKURA, WEST BENGAL**

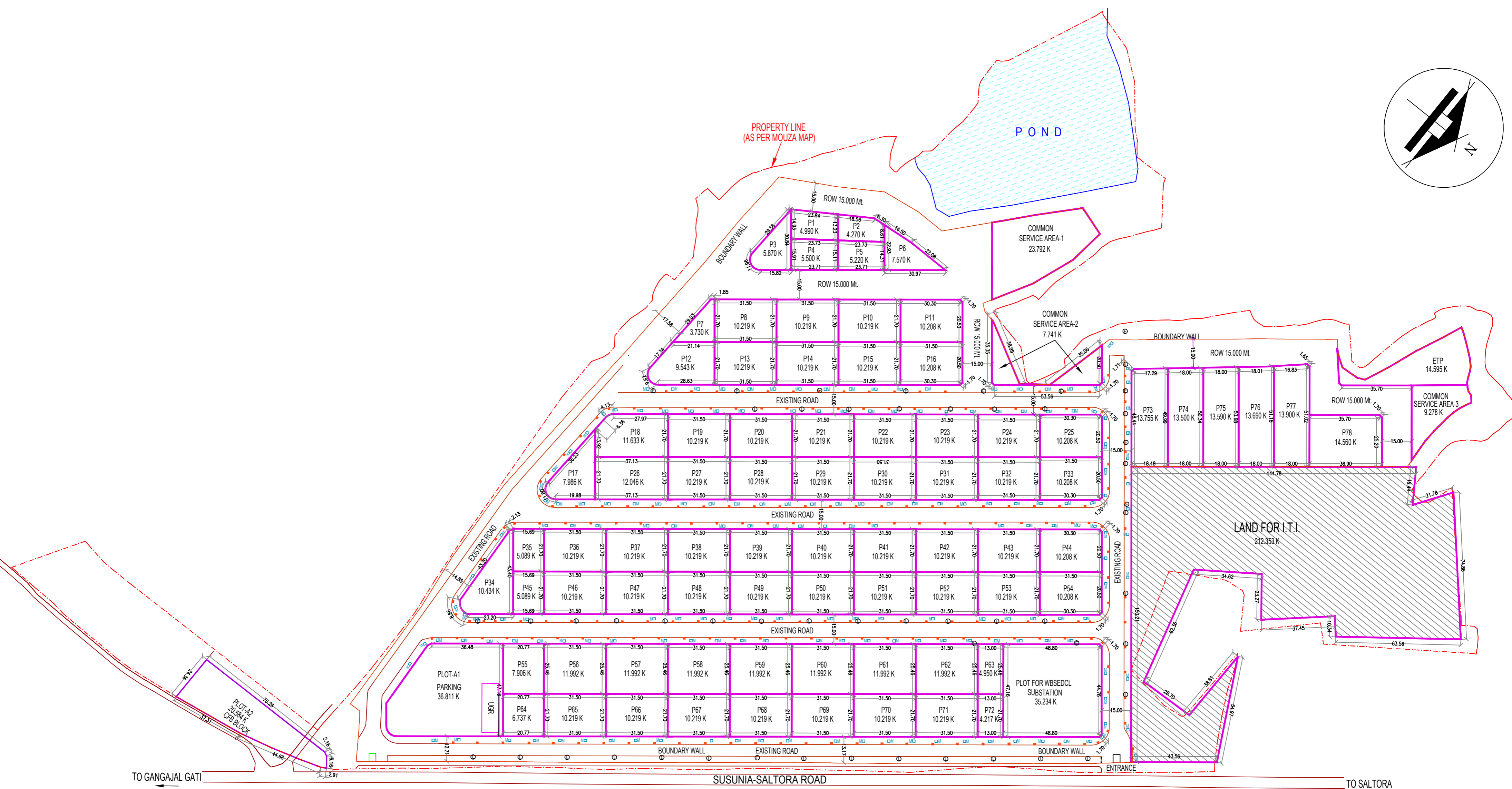
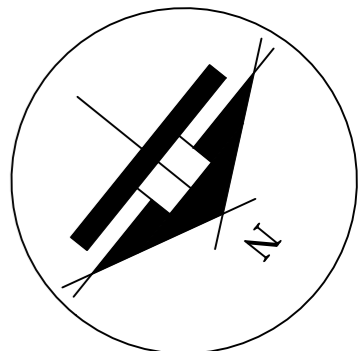

AREA STATEMENT OF PLOT

PLOT NO.	AREA (KATHA)	PLOT NO.	AREA (KATHA)	PLOT NO.	AREA (KATHA)	PLOT NO.	AREA (KATHA)
P1	4.990	P23	10.219	P45	5.089	P67	10.219
P2	4.270	P24	10.219	P46	10.219	P68	10.219
P3	5.870	P25	10.208	P47	10.219	P69	10.219
P4	5.500	P26	12.046	P48	10.219	P70	10.219
P5	5.220	P27	10.219	P49	10.219	P71	10.219
P6	7.570	P28	10.219	P50	10.219	P72	4.217
P7	3.730	P29	10.219	P51	10.219	P73	13.755
P8	10.219	P30	10.219	P52	10.219	P74	13.500
P9	10.219	P31	10.219	P53	10.219	P75	13.590
P10	10.219	P32	10.219	P54	10.208	P76	13.690
P11	10.208	P33	10.208	P55	7.906	P77	13.900
P12	9.543	P34	10.434	P56	11.992	P78	14.560
P13	10.219	P35	5.089	P57	11.992	PLOT FOR WBSIEDCL SUBSTATION	35.234
P14	10.219	P36	10.219	P58	11.992	COMMON SERVICE AREA-1	23.792
P15	10.219	P37	10.219	P59	11.992	COMMON SERVICE AREA-2	7.741
P16	10.208	P38	10.219	P60	11.992	COMMON SERVICE AREA-3	9.278
P17	7.986	P39	10.219	P61	11.992	ETP	17.878
P18	11.633	P40	10.219	P62	11.992	LAND FOR I.T.I.	212.353
P19	10.219	P41	10.219	P63	4.950	PLOT-A1 (PARKING)	36.811
P20	10.219	P42	10.219	P64	6.737	PLOT-A2 (CFB BLOCK)	20.584
P21	10.219	P43	10.219	P65	10.219		
P22	10.219	P44	10.208	P66	10.219		

NOTES:
 1. ALL DIMENSIONS ARE IN METRES, EXCEPT IF STATED OTHERWISE.
 2. SURVEY IS ORIENTATED TO TRUE NORTH OBSERVED BY DIFFERENTIAL GLOBAL POSITIONING SYSTEM (DGPS).

LEGEND

	TEMPORARY BENCH MARK
	GULLY PIT
	MANHOLE
	ELECTRIC POST
	LAMP POST
	PLOT DEMARCATON LINE

CLIENT:
 THE WEST BENGAL SMALL INDUSTRIES DEVELOPMENT CORPN. LTD.
 (A GOVERNMENT OF WEST BENGAL UNDERTAKING)

PLAN SHOWING DETAIL TOPOGRAPHICAL SURVEY
 GANGAJALGHATI INDUSTRIAL PARK
 DIST. BANKURA, WEST BENGAL

SCALE : 1:1000
 DRG NO. : WBSIDEL/GANGAJALGHATI/01
 SURVEYED BY: P Khanra, P Dutta

DWN. BY. Raja Das Gupta
 CHKD.
 SURVEYED ON: January 2024

RIDDHI MANAGEMENT SERVICES PVT. LTD.
 FE 297, SECTOR III, SALT LAKE CITY, KOLKATA - 700106