

CO-ORDINATE LIST OF REFERENCE POINT (UTM & LAT-LONG)

STATION	EASTING	NORTHING	Longitude (E)	Latitude (N)
TBM-1	538214.960	2599068.262	23° 30' 6.005"	87° 20' 41.672"
TBM-2	538256.620	2599132.771	23° 30' 7.121"	87° 20' 43.145"

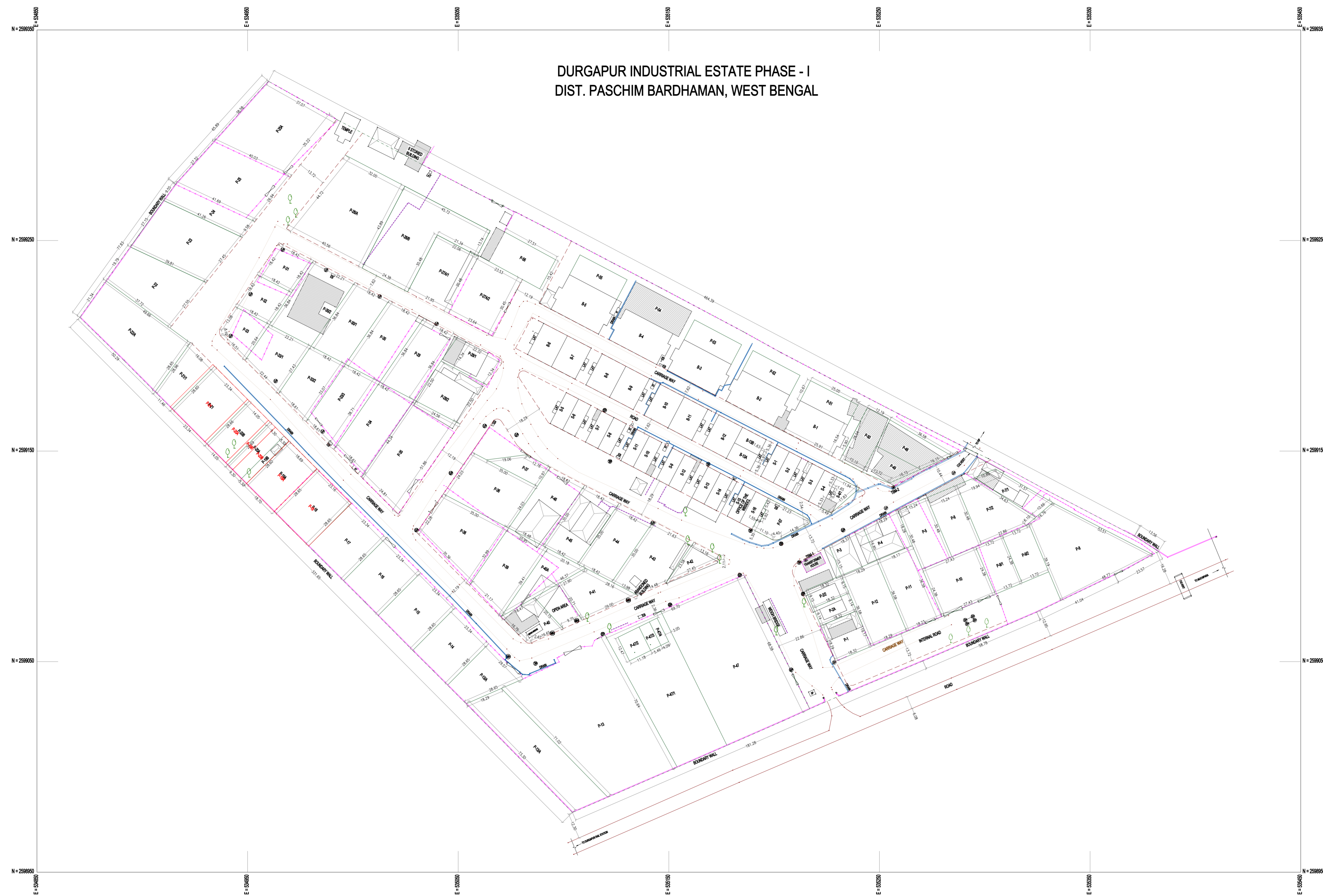

AREA STATEMENT

AREA		PLOTS		AREA	
PLOTS	ACRE	ACRE	KATHA	PLOTS	ACRE
B-1	0.11	0.06	P-29	0.17	10.29
B-2	0.11	0.06	P-30	0.17	10.29
B-3	0.11	0.06	P-301	0.17	10.29
B-4	0.11	0.06	P-302	0.20	12.10
B-5	0.11	0.06	P-31	0.08	4.84
B-6	0.05	3.03	P-32	0.08	4.84
B-7	0.05	3.03	P-33	0.08	4.84
B-8	0.05	3.03	P-331	0.13	7.87
B-9	0.05	3.03	P-332	0.14	8.47
B-10	0.05	3.03	P-333	0.16	9.86
B-11	0.05	3.03	P-34	0.19	11.59
B-12	0.05	3.03	P-35	0.29	17.55
B-13A	0.03	1.50	P-36	0.21	12.71
B-13B	0.03	1.50	P-37	0.05	3.03
P-1	0.08	4.84	P-38	0.24	14.52
P-2	0.04	2.42	P-39	0.19	11.50
P-3A	0.04	2.42	P-40	0.08	4.84
P-3	0.07	4.24	P-40A	0.10	5.95
P-4	0.08	4.84	P-41	0.12	7.26
P-41	0.03	1.91	P-42	0.05	3.03
P-5	0.12	7.26	P-43	0.16	9.89
P-6	0.12	7.26	P-44	0.16	9.89
P-7	0.08	4.84	P-45	0.16	9.89
P-7A	0.15	9.08	P-46	0.16	9.89
P-8	0.36	20.57	P-47	0.14	8.47
P-8A	0.08	4.84	P-47A	0.33	20.05
P-9	0.08	4.84	P-47B	0.03	2.00
P-10	0.17	10.29	P-47C	0.02	1.02
P-11	0.17	10.29	P-47D	0.01	0.58
P-12	0.17	10.29	P-48	0.12	7.26
P-13	0.77	46.31	P-49	0.08	4.84
P-13A	0.42	25.59	P-50	0.09	5.45
P-14	0.17	10.00	P-51	0.07	4.24
P-15	0.17	10.00	P-52	0.07	4.24
P-16	0.17	10.00	P-53	0.07	4.24
P-17	0.17	10.00	P-54	0.10	6.05
P-18	0.17	10.00	P-55	0.07	4.24
P-18A	0.14	8.35	P-56	0.11	6.66
P-18B	0.03	2.06	P-57	0.03	1.82
P-19A	0.07	4.17	S-1	0.03	1.82
P-20B	0.10	6.05	S-2	0.03	1.82
P-21	0.17	10.29	S-3	0.04	2.42
P-21A	0.03	1.89	S-4	0.03	1.82
P-22	0.22	13.31	S-5	0.03	1.82
P-22A	0.31	18.76	S-6	0.03	1.82
P-23	0.26	15.73	S-7	0.03	1.82
P-24	0.08	4.84	S-8	0.03	1.82
P-25	0.26	15.73	S-9	0.03	1.82
P-25A	0.27	16.34	S-10	0.03	1.82
P-26A	0.39	23.60	S-11	0.03	1.82
P-26B	0.36	22.76	S-12	0.03	1.82
P-27A	0.17	10.29	S-13	0.03	1.82
P-27A2	0.18	10.89	S-14	0.03	1.82
P-28	0.09	5.45	S-15	0.03	1.82
P-29	0.09	5.45	S-16	0.03	1.82
P-30	0.14	8.47	TOTAL	14.03	848.82

PARTICULARS	ACRE	KATHA	% ON TOTAL AREAS
PLOTS	14.03	848.82	89.66
INTERNAL ROAD	4.65	293.43	24.08
TRANSFORMER ROOM	0.01	0.61	0.05
ADMINISTRATIVE OFFICE (S-15)	0.03	1.82	0.15
OPEN AREA	1.22	73.81	6.06
TOTAL	20.14	1218.47	100.00

NOTES:

1. ALL DIMENSIONS ARE IN METRES, EXCEPT IF STATED OTHERWISE.
2. SURVEY IS ORIENTATED TO TRUE NORTH OBSERVED BY DIFFERENTIAL GLOBAL POSITIONING SYSTEM (DGPS).
3. PROPERTY AREA = 20.14 Acre / 1218.47 Katha

LEGEND			
⊕	TRaverse POINT	---	BOUNDARY WALL
⊕	TEMPORARY BENCH MARK	- - - -	PROPERTY LINE
⊕	ELECTRIC POST	⊕	GATE
⊕	LAMP POST	LAT	LATRINE
⊕	TELEPHONE POST	SP	SEMI PUCCA BUILDING
■	PILLAR (PROPERTY LIMIT)	▨	BUILDING
○	TREE	▨	SHED
---	FENCE LINE		

THE WEST BENGAL SMALL INDUSTRIES DEVELOPMENT CORPN. LTD.  
(A GOVERNMENT OF WEST BENGAL UNDERTAKING)

PLAN SHOWING DETAIL TOPOGRAPHICAL SURVEY OF DURGAPUR INDUSTRIAL ESTATE PHASE-I  
DIST. PASCHIM BURDWAN, WEST BENGAL.

SCALE : 1:1500  
DRG NO. : WBSIDELDURGA-PH-01  
SURVEYED BY : P Khanna, P Dutta

DWN. BY: Raju Das Gupta  
CHKD.  
SURVEYED ON:

RIDDHI MANAGEMENT SERVICES PVT. LTD.  
FE 297, SECTOR III, SALT LAKE CITY, KOLKATA - 700106