

SHIBPUR INDUSTRIAL ESTATE, PHASE-I
DIST. HOWRAH, WEST BENGAL

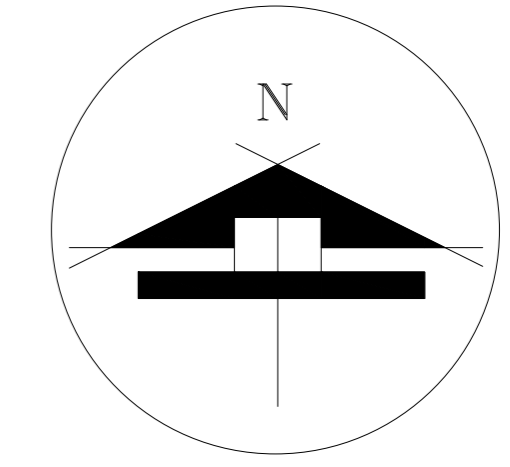

LEGEND

	TEMPORARY BENCH MARK
	TRAVERSE POINT
	TREE
	BOUNDARY WALL
	PROPERTY LINE
	PLOT BOUNDARY

AREA STATEMENT

PLOT NO.	AREA
PLOT NO. 1	0.75 Acre / 45.36 Katha
PLOT NO. 2	0.17 Acre / 10.00 Katha
PLOT NO. 3A	0.14 Acre / 8.33 Katha
PLOT NO. 3B	0.14 Acre / 8.55 Katha
TOTAL	1.20 Acre / 72.24 Katha

SL NO.	PARTICULARS	AREA	% ON TOTAL AREA
1	PLOTS	1.20 Acre / 72.60 Katha	99.17
2	COMMON SERVICE AREA	-	-
	ELECTRIC ROOM	0.01 Acre / 0.48 Katha	0.83
3	INTERNAL ROAD	-	-
	CORRIDOOR	-	-
4	OPEN SPACE	-	-
	TOTAL	1.208 Acre / 73.08 Katha	100.00

CO-ORDINATE LIST OF TBM'S (UTM & LAT-LONG)

STATION	EASTING	NORTHING	Longitude (E)	Latitude (N)
TBM-1	634325.012	2495601.453	88°18'22.4"	22°33'43.33"
TBM-2	634329.489	2495575.479	88°18'11.4"	22°33'27.33"

NOTES:

1. ALL DIMENSIONS ARE IN METRES, EXCEPT IF STATED OTHERWISE.
2. SURVEY IS ORIENTATED TO TRUE NORTH OBSERVED BY DIFFERENTIAL GLOBAL POSITIONING SYSTEM (DGPS).
3. PROPERTY AREA = 1.208 Acre / 73.08 Katha

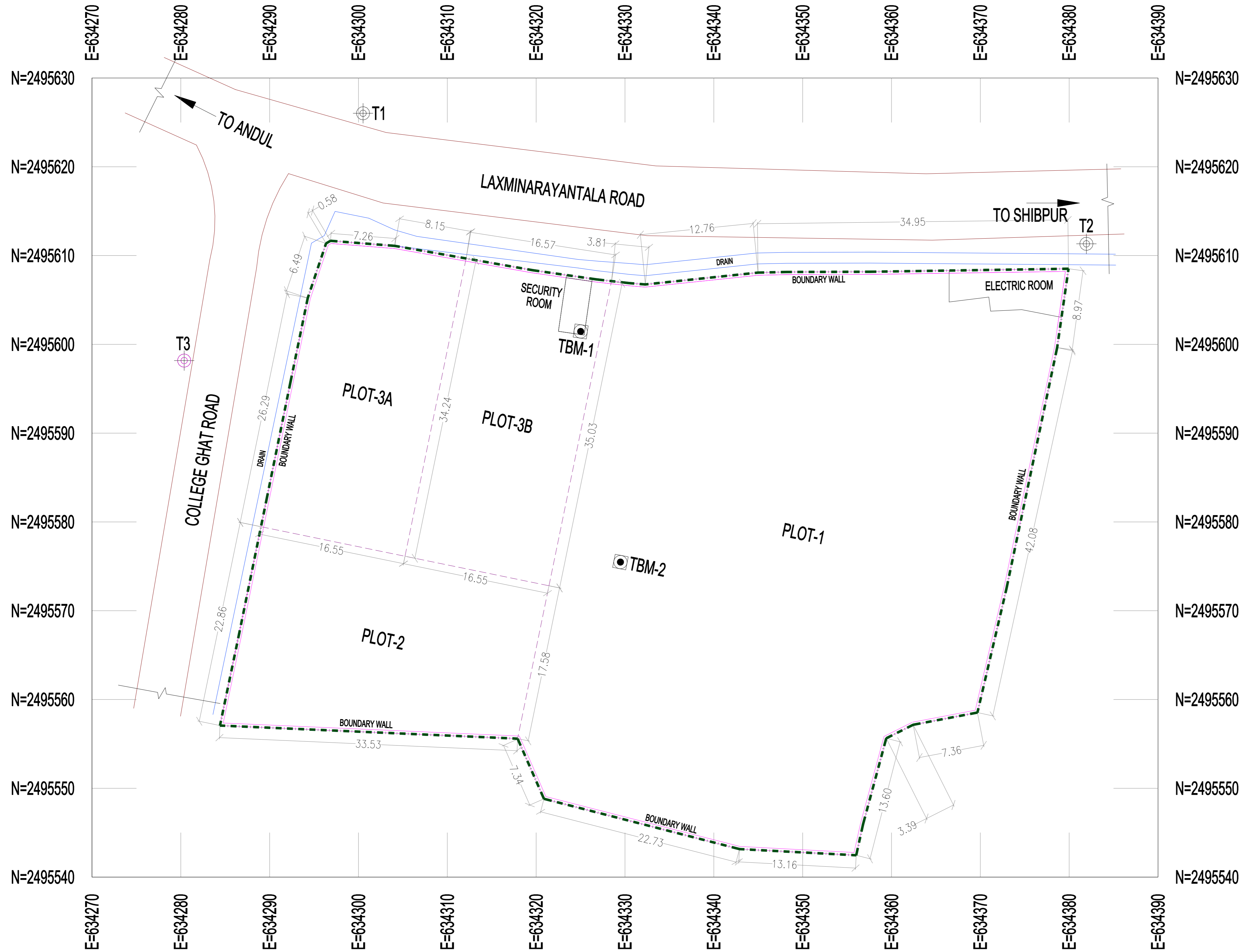

CLIENT:

THE WEST BENGAL SMALL INDUSTRIES DEVELOPMENT CORPN. LTD.
(A GOVERNMENT OF WEST BENGAL UNDERTAKING)

PLAN SHOWING DETAIL TOPOGRAPHICAL SURVEY OF SHIBPUR INDUSTRIAL ESTATE-I
DIST. HOWRAH, WEST BENGAL

SCALE : 1:500 DWN. BY. Raja Das Gupta

DRG NO. : WBSIDEL/BAURIA/01 CHKD.

SURVEYED BY: P Khanra, P Dutta SURVEYED ON:

RIDDHI MANAGEMENT SERVICES PVT. LTD.

FE 297, SECTOR III, SALLAKE CITY, KOLKATA - 700106