

**DABGRAM INDUSTRIAL ESTATE PHASE-I
DIST. JALPAIGURI**

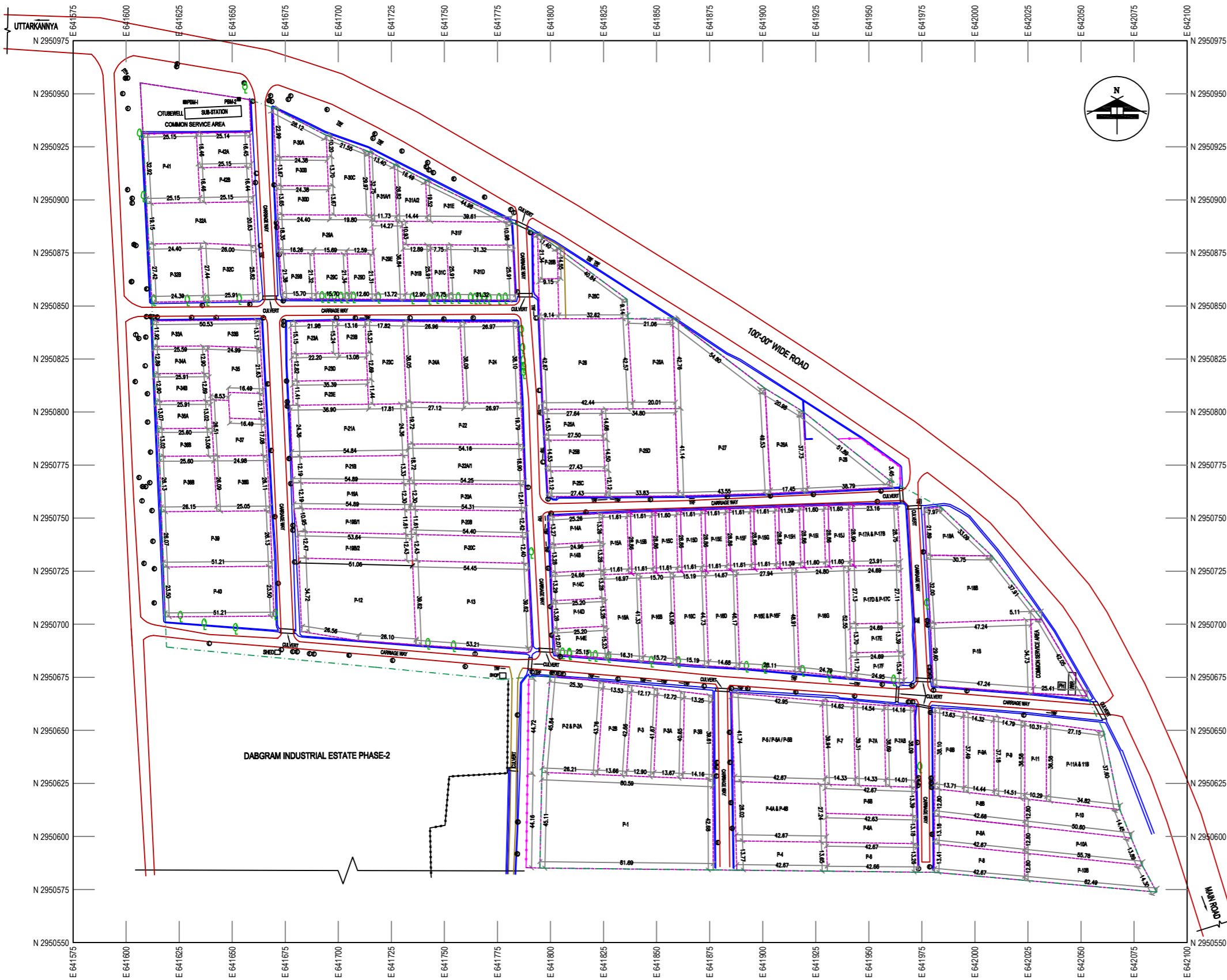

AREA STATEMENT					
PLOT	AREA		PLOT	AREA	
	ACRE	KATHA		ACRE	KATHA
1	0.88	53.30	198/1	0.17	10.00
2 & 2A	0.29	17.37	198/2	0.17	10.00
2B	0.15	8.96	20A	0.17	10.00
3	0.27	16.42	20B	0.17	10.00
3A & 3B	0.27	16.42	20C	0.17	10.00
4	0.14	8.72	21A	0.33	20.00
4A & 4B	0.29	17.64	21B	0.17	10.00
5, 5A & 5B	0.43	25.94	22	0.26	16.00
6	0.14	8.57	22A/1	0.25	15.13
6A	0.14	8.56	23A	0.08	5.00
6B	0.14	8.65	23B	0.05	3.00
7	0.14	8.44	23C	0.18	11.00
7A & 7B	0.27	16.45	23D	0.11	6.75
8	0.14	8.36	23E	0.10	6.00
8A	0.14	8.29	24	0.25	15.36
8B	0.14	8.17	24A	0.25	15.36
9	0.13	8.12	25A & 25B	0.20	12.00
9A	0.13	8.03	25C	0.08	5.00
9B	0.13	7.73	25D	0.34	20.81
10	0.15	9.14	26	0.44	26.63
10A	0.17	10.16	26A	0.21	12.64
10B	0.19	11.32	26B	0.05	3.00
11	0.09	5.67	26C	0.17	10.00
11A, 11B/2 & 11B	0.28	16.67	27	0.71	42.78
12	0.48	29.25	28	0.20	12.00
13	0.53	31.96	28A	0.20	12.00
14A	0.08	5.00	29A & 29B	0.28	17.15
14B	0.08	5.00	29C	0.08	5.00
14C	0.08	5.00	29D	0.07	4.00
14D	0.08	5.00	29E	0.12	7.50
14E	0.08	5.00	30A & 30B	0.18	11.00
15A	0.08	5.00	30C	0.17	10.00
15B	0.08	5.00	30D	0.08	5.00
15C	0.08	5.00	31A/1	0.08	5.00
15D	0.08	5.00	31A/2	0.08	5.00
15E	0.08	5.00	31B, 31C & 31D	0.33	20.13
15F	0.08	5.00	31E	0.10	5.75
15G	0.08	5.00	31F	0.14	8.53
15H	0.08	5.00	32A	0.25	15.00
15I	0.08	5.00	32B	0.17	10.00
15J	0.08	5.00	32C	0.17	10.00
16A	0.17	10.00	33A	0.07	4.00
16B	0.17	10.00	33B	0.08	5.00
16C	0.17	10.00	34A	0.08	5.00
16D	0.17	10.00	34B	0.08	5.00
16E & 16F	0.33	20.00	35	0.14	8.60
16G	0.31	18.90	36A	0.08	5.00
17A & 17B	0.17	10.00	36B	0.08	5.00
17C & 17D	0.17	10.00	37	0.12	7.40
17E	0.08	4.95	38A	0.17	10.00
17F	0.08	4.95	38B	0.17	10.00
18	0.38	22.71	39	0.33	20.00
18A	0.11	6.50	40	0.30	18.00
18B	0.31	19.00	41	0.20	12.37
19A	0.17	10.00	42A	0.10	6.19
			42B	0.10	6.19
			TOTAL	20.13	1217.87

PARTICULARS	AREA		% ON TOTAL AREAS
	ACRE	KATHA	
TOTAL PLOT	20.13	1217.87	82.08
COMMON SURVIVE AREA (ZCOS)	0.43	26.02	1.55
INTERNAL ROAD	3.94	238.37	16.37
TOTAL AREA	24.50	1482.25	100.00

CO-ORDINATE LIST OF REFERENCE POINT (UTM & LAT-LONG)

STATION	EASTING	NORTHING	Longitude (E)	Latitude (N)
PBM-1	641627.717	2950946.120	26° 16' 58.004" E	88° 13' 18.479" N
PBM-2	641653.138	2950947.448	26° 16' 57.767" E	88° 13' 17.616" N

LEGEND

- PERMANENT BENCH MARK
- ELECTRIC POST
- LAMP POST
- TELEPHONE POST
- VALVE CHAMBER
- TREE
- BOUNDARY WALL
- PROPERTY LINE
- PLOT DEMARCATION LINE
- FENCE
- GATE
- ELECTRIC JOINT BOX
- TELEPHONE BOX
- TRANSFORMER
- UNDERGROUND WATER RESERVOIR
- PUMPHOUSE

NOTES:
 1. ALL DIMENSIONS ARE IN METRES, EXCEPT IF STATED OTHERWISE.
 2. SURVEY IS ORIENTATED TO TRUE NORTH OBSERVED BY DIFFERENTIAL GLOBAL POSITIONING SYSTEM (DGPS).
 3. PROPERTY AREA = 24.50 Acre / 1482.25 Katha

CLIENT:
THE WEST BENGAL SMALL INDUSTRIES DEVELOPMENT CORPN. LTC
 (A GOVERNMENT OF WEST BENGAL UNDERTAKING)

**PLAN SHOWING DETAIL TOPOGRAPHICAL SURVEY OF DABGRAM INDUSTRIAL ESTATE PHASE-I
DIST. JALPAIGURI**

SCALE : 1:1000	DWN. BY: Raja Das Gupta
DRG NO. : WBSIDCL/DAB-I/01	CHKD.
SURVEYED BY: P Khanra, P Dutta	SURVEYED ON: 10.02.2025

RIDDHI MANAGEMENT SERVICES PVT. LTD.
 FE 297, SECTOR III, SALT LAKE CITY, KOLKATA - 700106